



 *Burris*[®]
FIND WHAT MATTERS

2022 | HUNT



FIND WHAT MATTERS

IN A BURRIS OPTIC

2022 NEW PRODUCTS	3
BURRIS TECHNOLOGY	4
HUNTING	6
BURRIS CYBER CORE	8
THERMAL H-SERIES	10
THERMAL C-SERIES	12
THERMAL SCOPES	14
BALLISTIC® III LASERSCOPE®	16
FOUR Xe RIFLESCOPES	22
SIX Xe RIFLESCOPES	24
FULLFIELD E1™ RIFLESCOPES	26
RT-6 RIFLESCOPE™	28
RT-1	30
FASTFIRE™	32

RINGS AND MOUNTS	34
RINGS AND MOUNTS	36
HUNTING PRODUCT SPECS	42



2022 NEW PRODUCTS

H-Series



NEW THERMAL HAND-HELDS

Page 8

With a modern, lightweight design the Thermal Handheld has the ability to hot track targets over 750 meters away. The smooth zoom and real time wifi-to-mobile connection keeps you locked on your target.

C-Series



NEW THERMAL CLIP-ONS

Page 10

Use the Clip-on as a handheld tracker or turn any scope into a thermal scope with a simple attachment. The Clip-on's 4 power zoom and 4 color palettes ensures nothing will make it through your sight picture unnoticed.

SIX Xe



NEW SIX Xe RIFLESCOPES

Page 20

Everything about the Burris SIX Xe was designed for competition and tactical shooting. It's short and lightweight for quicker, easier handling. The 1x is ideal for both-eyes-wide-open target acquisition while the 3-18x56 allows for great flexibility in any situation.

NEW FASTFIRE PRODUCTS

Page 22

Introducing one sight for any weapon platform, any tactical competition, any form of defense, any style of hunting: FastFire. Evolved, refined and advanced for 10 years, with new red dot options, longer battery life, and greater versatility, there's a battle-ready FastFire for every kind of firearm and any kind of shooting.

FASTFIRE IV



FASTFIRE RD





BURRIS TECHNOLOGY

Premium optical glass and top-quality lens coatings ensure that the best image possible is delivered every time you look through a Burris scope. The durable construction and precise, easy-to-use adjustment system gives you the confidence that your Burris scope will perform reliably every time. With the added benefits of being fogproof, waterproof and shockproof, feel secure that your Burris scope will endure whatever Mother Nature throws at you.

PREMIUM OPTICAL QUALITY



Burris uses high-grade optical glass and design prescriptions specifically for each lens inside each scope. Lens prescription tolerances are measured in 1/10,000,000 of an inch. 100% of lenses are inspected multiple times during lens and scope production.

TOP-QUALITY LENS COATINGS

Burris uses anti-reflective and scratch resistant coatings so the best optical glass can perform even better.

Burris Index-Match HiLume™ Multicoating

- Maximizes light transmission for premium image quality
- Minimizes glare for better visibility
- 99.5 to 99.8% light transmission per lens surface



USING HIGH-QUALITY BURRIS LENS COATINGS ON EVERY LENS SURFACE ENSURES THE BEST IMAGE POSSIBLE IS DELIVERED TO YOUR EYE.

Scratch Resistant Coating

- Placed on top of the anti-reflective coating to prevent lens damage
- Extends the life of the scope by preventing dings and scratches

RUGGED CONSTRUCTION

Advanced engineering and attention to detail create rugged, reliable riflescopes that will endure a lifetime of hard use.

6061 T-6 aluminum scope tubes

- 35,000 – 40,000 PSI yield strength
- Corrosion resistant

Solid one-piece tube design

- Machined from a single piece of seamless aluminum tubing
- Lightweight and very strong.

Double Internal Spring System

- Provides nearly double the force of single spring systems to ensure that point of impact will not shift

Precision-gauged, hand-fitted parts

- Perfect fit of internal parts guarantees accurate performance

PRECISION ADJUSTMENT SYSTEM

Every Burris riflescope features a steel-on-steel adjustment system that is positive and repeatable, with audible clicks.

Accurate and positive adjustments

- Precise tolerances ensure that each click moves the point-of-impact the correct amount
- Hardened steel-on-steel designs for long-term performance
- Finger-adjustable clicks are both tactile and audible

Wide variety of shooter and situation specific options

- Low or high profile adjustment knobs
- MOA or Mil increments, dimensionally matched to the reticle
- “M.A.D.” System (Modular Adjustment Dial System) available on premium riflescope lines



HUNT PRODUCT

TRUST US WITH YOUR HUNT.

Finding corners of the world still devoid of a cell signal. The relationships solidified while hanging a trophy deer in camp. The laughter around the campfire as the last flame hangs on. Those familiar with Burris know well what matters. It's about self-reliance. Respect for the game and those you hunt beside. Pushing yourself season after season to be your absolute best. For more than 40 years we've been right there with you, pushing ourselves for the same reasons: We know exactly how much the season means to us, and that's why you can forever trust your hunt to Burris.







BURRIS CYBER CORE

FAST.

FASTEST REFRESH RATES
INSTANT ON - POWER SAVE FUNCTION
REAL TIME MOBILE CONTROL &
CONNECTIVITY
RAPID HOT TRACK



SIMPLE.

TWIST TUNE - FOCUS WHEEL
EASY ADJUSTMENT - BRIGHTNESS AND CONTRAST
READY TO GO OUT OF THE BOX

POWERFUL.

FULL SPECTRUM - CONTRAST AND BRIGHTNESS
PENETRATING FOCUS -
OPERATE IN ALL CONDITIONS
STRONG COLOR PALLETS -
WHITE, BLACK, RED, IRON AND BLUE
BEST-IN-CLASS SENSOR - 400X300 THERMAL



BURRIS THERMAL SCOPE



BURRIS THERMAL HANDHELD



BURRIS THERMAL CLIP-ON



INTRODUCING THERMAL SERIES



Burris

FIND WHAT MATTERS

WWW.BURRISOPTICS.COM/THERMAL



Burris

INTRODUCING THERMAL SERIES

HANDHELD

BURRIS
CYBER CORE
FAST. SIMPLE. POWERFUL.



The brand new hand-held thermal series "H" from Burris is the perfect portable thermal camera for professional hunters and offers a selection of three different objective lens sizes (25mm/35mm/50mm). With his 400x300 IR-Sensor and the state-of-the-art 1280x960 HD-Display the "H" series is built for any kind of hunters needs and guarantees a impressive sharp and crystal clear thermal image.



THERMAL HAND-HELDS

With a modern, lightweight design the Thermal Handheld has the ability to hot track targets over 750 yards away. The smooth zoom and real time wifi-to-mobile connection keeps you locked on your target.

NEW BTH25

ITEM NUMBER:
300467

Objective size 25 mm

- 27x20m Field of view on 100 m
- 400x300 thermal sensor for accurate identification
- Zoom Range 1.7 - 6.8

NEW BTH35

ITEM NUMBER:
300468

Objective size 35 mm

- 2.3x to 9.2x zoom range to track targets
- 400x300 thermal sensor for accurate identification
- 35mm f/1.2 focal length for wide field of view

NEW BTH50

ITEM NUMBER:
300469

Objective size 50 mm

- 3.3x to 13.2x zoom range for any range
- 400x300 thermal sensor for accurate identification
- 50mm f/1.2 focal length for extended range



2 YEARS

Burris Thermal Optics Warranty

[www.burrisoptics.com/
customer-service/warranty/
thermal/international](http://www.burrisoptics.com/customer-service/warranty/thermal/international)

H-SERIES FEATURES

- Full HD Color Display with 1280 x 960 Pixel
- User friendly manual with mobile app
- HDMI-Videooutput
- Integrated staditometric rangefinder
- Stepless Zoom function
- Recognition 3000 m
- Detection 1400 m

BURRIS CYBERCORE. FAST, SIMPLE, POWERFUL

All Burris Thermal devices are equipped with the unique Burris Cybercore which allows for fast detection, simple usability and powerful precision. The built in presets allow for immediate use letting you focus on what matters: the hunt.



Burris
**INTRODUCING
 THERMAL SERIES**
 CLIP-ON

**BURRIS
 CYBER CORE**

FAST. SIMPLE. POWERFUL.

Change the night into day with the versatile thermal clip-on "C"-series from Burris. The outstanding image quality, the compact size and the lightweight building makes the "C"-series the perfect tool for any kind of hunting situation and a trustful and reliable part of your equipment.



WATERPROOF



SHOCKPROOF



FOGPROOF



NITROGEN-FILLED



THERMAL CLIP-ONS

Use the Clip-on as a handheld tracker or turn any scope into a thermal scope with a simple attachment. The Clip-on's 4 power zoom and 4 color palettes ensures nothing will make it through your sight picture unnoticed.

NEW BTC35

Objective size 35 mm

ITEM NUMBER:
300629

- 1x, 2x, and 4 zoom for any distance
- 400x300 pixel resolution for accurate target identification
- 35mm f/1.2 focal length for wide field of view



NEW BTC50

Objective size 50 mm

ITEM NUMBER:
300628

- 1x, 2x, and 4x zoom for any distance
- 400x300 pixel resolution for accurate target identification
- 50mm f/1.2 focal length for extended range



2 YEARS

Burris Thermal Optics Warranty

[www.burrisoptics.com/
customer-service/warranty/
thermal/international](http://www.burrisoptics.com/customer-service/warranty/thermal/international)

C-SERIES FEATURES

- Full Color OLED-Display
- Easy to mount on analog hunting scopes
- "Plug and Play", repeatable mounting without new settings
- Lightweight with less than 400 gramm
- Wide Palett of color modes
- Function down to -30 degrees
- Recognition up to 2400 m
- Detection up to 1000 m

BURRIS CYBERCORE. FAST, SIMPLE, POWERFUL

All Burris Thermal devices are equipped with the unique Burris Cybercore which allows for fast detection, simple usability and powerful precision. The built in presets allow for immediate use letting you focus on what matters: the hunt.



BURRIS CYBER CORE

FAST. SIMPLE. POWERFUL.

Burris

INTRODUCING THERMAL SERIES

SCOPES

Offering 4 power zoom, hot tracking over 750 yards, stadiametric ranging and 5 unique color palettes – this scope is packed with features to help you own the night.



WATERPROOF



SHOCKPROOF



FOGPROOF



NITROGEN-FILLED



BTS RETICLES

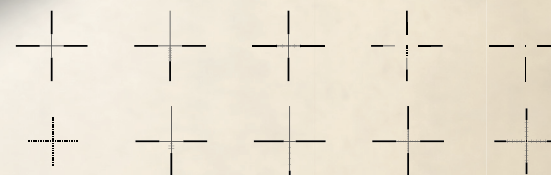

THERMAL RIFLESCOPIES

The Burris Thermal Rifle scope is packed with features that will help you take night hunting to a whole new level! Offering 4 power zoom, hot track, stadiametric ranging and 5 unique color palettes – this scope is packed with features to help you own the night.

NEW BTS 35

ITEM NUMBER:
300619

Objective size 35 mm

- 2.3–9.2x magnification to track targets
- 400x300 pixel resolution for accurate target identification
- 35mm f/1.2 focal length for wide field of view

NEW BTS 50

ITEM NUMBER:
300618

Objective size 50 mm

- 3.3–13.2x magnification for distant targets
- 400x300 pixel resolution for accurate target identification
- 50mm f/1.2 focal length for extended range to zoom for any distance



2 YEARS

Burris Thermal Optics Warranty

[www.burrisoptics.com/
customer-service/warranty/
thermal/international](http://www.burrisoptics.com/customer-service/warranty/thermal/international)

S-SERIES FEATURES

- 7 color palettes
- Stadiametric ranging
- 10 reticle options
- Hot track
- Manual and auto NUC
- Adjustable contrast
- Adjustable brightness
- Intuitive, one-hand operation
- IP67

BURRIS CYBERCORE. FAST, SIMPLE, POWERFUL

All Burris Thermal devices are equipped with the unique Burris Cybercore which allows for fast detection, simple usability and powerful precision. The built in presets allow for immediate use letting you focus on what matters: the hunt.



BALL!STIC

LASERSCOPE® III

1 OPTIC - 4 TOOLS



PRECISION
OPTIC



DIGITAL
INCLINOMETER



SMART
DOPE CARD



LASER
RANGE FINDER



BALLISTIC[®] LASERSCOPE[®] III

The **Ballistic[®] III LaserScope[™]** is the most innovative and effective hunting riflescope in the world. Combining outstanding optics, pinpoint laser rangefinding, and precision trajectory compensation for the exact ammunition you choose for your hunt, it eliminates most of the variables and guesswork that often cause hunters to go home empty-handed. In one fast sequence the Ballistic III determines the distance to your target, factors in your trajectory and illuminates the perfect holdover. It's that simple.

The Ballistic III significantly extends the range and accuracy of your favorite rifle. No other riflescope combines the level of quality, technology, accuracy, repeatability, speed and effectiveness. It will greatly increase the distance at which you can make an ethical shot.



KEY FEATURES

- **Built-In Laser Rangefinder.** Laser range capability out to 1,100-plus meters with reflective target, 690-plus meters with non-reflective target.
- **Automatic Trajectory Compensation.** Customized trajectory compensation calculates the perfect holdover at your exact distance for your specific cartridge. Trajectory compensation works on any magnification.
- **Integrated Inclinometer.** Integrated inclinometer adjusts for any angle on uphill or downhill shots.
- **Wind Hold-Off.** Scope displays a 16 kmh Wind Value to indicate wind hold-off for your specific cartridge at the indicated range to target. Wind Value represents how many dots to hold into the wind for a 16 kmh crosswind.
- **No Rings Required.** Riflescope comes with its own bases that attach to any Weaver-style or Picatinny base.

EASY PROGRAMMING

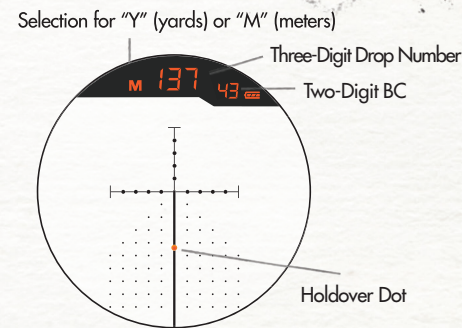

Three simple steps:

1. Select Yards or Meters.
2. Enter Drop Number.
3. Enter Ballistic Coefficient.

WINDAGE COMPENSATION

While complete wind compensation is not fully automated within the scope, it gives the shooter the tools needed to make a calculated hold-off estimate. In addition to distance, the scope's digital display will show a 16 kmh Wind Value for your specific cartridge at the indicated range to your target.



www.burrisoptics.eu/en/scopes/laser-riflescopes/ballistic-iii-laserscope-series



Example 300 meters | 16-kmh crosswind
shooter holds .9 dots into the wind



Example 500 meters | 16-kmh crosswind
shooter holds 1.7 dots into the wind



Burris[®] **BALLISTIC III** LASERSCOPE



Two words: no guesswork. It's plug and play in a rangefinding scope that goes even bigger: Just feed the Ballistic III your cartridge's ballistic info and the scope calculates perfect holdover at your exact distance, estimates wind drift, then gives you the bright red dot of accuracy in seconds — all at the push of a button.



WATERPROOF



SHOCKPROOF



FOGPROOF



NITROGEN-FILLED

RETICLE

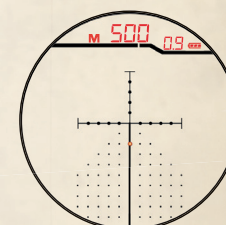

X96 Reticle

BALLISTIC III LASERSCOPE 4-16x50mm

ITEM NUMBER:

200117

RETICLE:

X96 RETICLE

ADJUSTABLE PARALLAX:

50 M TO INFINITY

- Features Remote Cable Switch for convenient operation of On/Range button; expanded ballistic capability accommodates centerfire, rimfire, muzzleloader and slug gun loads
- High magnification extends your long-range shooting capability
- 50 mm objective allows for maximum light transmission
- Strong, low mounting system with its own bases mounts to any Weaver-style or Picatinny base; no rings required
- Reticle displays a 16 kmh Wind Value to indicate wind hold-off for your specific cartridge at the indicated range to target; you estimate the actual wind speed and use the Wind Value as a guide to determine the number of dots to hold into the wind



SERIES FEATURES

- Customized trajectory compensation calculates the perfect holdover at your exact distance; program your cartridge's ballistics information, push a button, and a bright red, illuminated dot signifies your new aiming point in a split second
- Built-in laser rangefinder features 1,100+ meters ranging capability
- Trajectory compensation is accurate at any magnification
- Integrated inclinometer compensates for shots at any uphill or downhill angle

TRIPLE THREAT IN THE WOODS

The Ballistic 4-16x50 (Model #200117) now has enhanced ballistic software that makes it a triple threat in the woods. Not only will it work for centerfire cartridges, but will now work on most rimfire, muzzleloader and slug guns as well.



Burris FOUR Xe RIFLESCOPES



★★★★★
FOREVER WARRANTY
★ NO QUESTIONS ASKED ★

Step into legendary Burris performance with a scope that steps up your game. Our reliable, high-quality glass is glare-resistant and superbly capable in low light, with a shockproof design that gives you the most for your dollar and more.



WATERPROOF



SHOCKPROOF



FOGPROOF



NITROGEN-FILLED

RETICLES



Reticle 4 illuminated

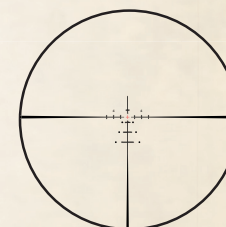

Ballistic E3

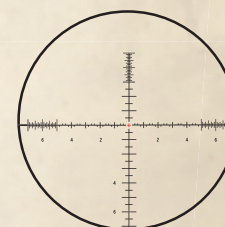

SCR MIL

FOUR Xe RIFLESCOPE 1-4x24 mm

ITEM NUMBERS:
200502

- The best choice for driven hunts.

RETICLE:
4 ILLUMINATED

MAIN TUBE SIZE:
30 MM



FOUR Xe RIFLESCOPE 2,5-10x50 mm

ITEM NUMBERS:
200503

- Versatile and lightweight for daytime use.

RETICLE:
4 ILLUMINATED

MAIN TUBE SIZE:
30 MM



FOUR Xe RIFLESCOPE 3-12x56 mm

ITEM NUMBER:
200504

- 56 mm objective allows for maximum light collection

RETICLE:
4 ILLUMINATED

MAIN TUBE SIZE:
30 MM



FOUR Xe RIFLESCOPE 6-24x56 (Low Profile Turrets) 6-24x50 (High Profile Turrets)

200505 (LOW PROFILE)
200506 (HIGH PROFILE)

- The long range specialist with precise elevation adjustment.
Two models available for hunting and long-range shooting.

RETICLE:
**BALLISTIC E3 RFP (6-24x56)
SCR MIL (6-24x50)**

MAIN TUBE SIZE:
30 MM



HIGH PROFILE TURRETS



SERIES FEATURES

- Low-Profile Adjustment Knobs
- Four Times Magnification Range
- Illuminated Reticles to provide a bright center point for aiming in all lighting conditions
- High Performance Glass – Provides excellent brightness and clarity with lasting durability
- Double Spring-Tension Internal Assemblies – Built to withstand the harshest shooting environments

DESIGNED FOR EUROPE

The Burris FourXe™ riflescope line offers advanced optical design with an illuminated reticle to adapt to any lighting condition. FourXe™ riflescopes offer tremendous performance and value with a variety of features.



NEW *Burris*
SIX Xe
RIFLESCOPES



★★★★★
FOREVER WARRANTY
★ NO QUESTIONS ASKED ★

The Burris Six Xe riflescope line offers advanced optical design with an illuminated reticle to adapt to any lighting condition. Six Xe riflescopes offer tremendous performance and value to your shooting experience.



WATERPROOF



SHOCKPROOF



FOGPROOF



NITROGEN-FILLED

RETICLES



4Ai illuminated

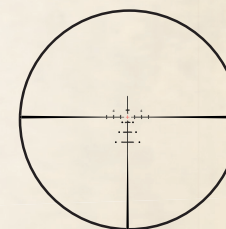

Ballistic E3

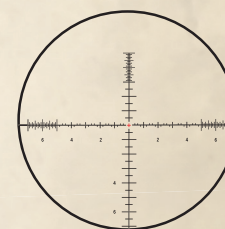

SCR MIL

SIX Xe RIFLESCOPE 1-6x24 mm

ITEM NUMBERS:
200626

RETICLE:
4AI ILLUMINATED

MAIN TUBE SIZE:
30 MM

- The best choice for driven hunts.
- Six Times Zoom System allows a larger field-of-view and better target acquisition
- High-Performance Glass provides excellent brightness and clarity with lasting durability



NEW

SIX Xe RIFLESCOPE 3-18x56 mm

ITEM NUMBER:
200627

RETICLE:
BALLISTIC E3 RFP

MAIN TUBE SIZE:
30 MM

- 56 mm objective allows for maximum light collection
- Push-Pull Locking Turrets have locking caps that prevent accidental movement and loss of zero
- Precise Windage & Elevation Adjustment is accurate, repeatable, fast, and easy



ITEM NUMBER:
200628

RETICLE:
SCR MIL

MAIN TUBE SIZE:
30 MM

SERIES FEATURES

- Low- and High-Profile Adjustment Knobs. Finger-adjustable windage and elevation adjustment.
- Six Times Magnification Range. Six times zoom system gives you a large field of view at close ranges and helps with target acquisition at longer range.
- Choice of Reticles. Depending upon the model, your scope will have either the German 3P #4, Ballistic Plex E3TM or SCR MIL reticle. All reticles are illuminated to provide a bright center point for aiming in all lighting conditions.

DESIGNED FOR EUROPE

This premium riflescope will be your best asset in the field, helping you bag big game or quick varmints with precision reticles and high-quality glass.



Burris

FULLFIELD E1™

RIFLESCOPES

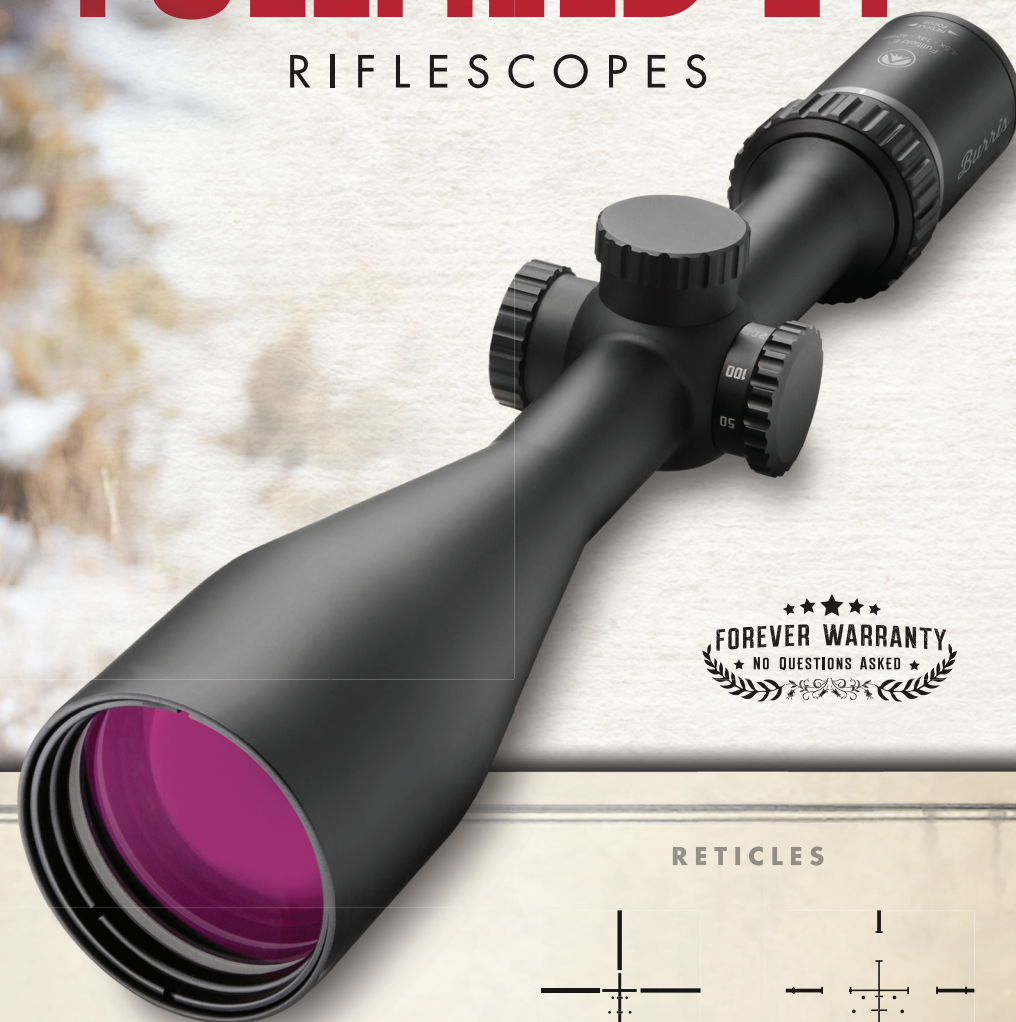

★★★★★
FOREVER WARRANTY
★ NO QUESTIONS ASKED ★

If you had to pick just one scope to have in your safe, the Fullfield E1 would be a sure winner. No matter where or how you hunt—from whitetail in the woods to elk in the Rockies—the Fullfield E1 will help you fill your freezer.



WATERPROOF



SHOCKPROOF



FOGPROOF



NITROGEN-FILLED

RETICLES



Ballistic Plex
E1™

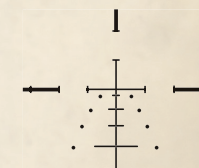

Ballistic Plex
E1™ MV

FULLFIELD E1 RIFLESCOPE 3-9x40mm

ITEM NUMBERS:
200320

RETICLE:
BALLISTIC PLEX E1™

MAIN TUBE SIZE:
1 in. (25,4 mm)

- Most popular and versatile model
- Available illuminated reticle has 10 settings from low light to daylight; reduces time to get on target in any lighting condition and increases accuracy when target is dark



FULLFIELD E1 RIFLESCOPE 4.5-14x42mm

ITEM NUMBER:
200338

RETICLE:
BALLISTIC PLEX E1™

MAIN TUBE SIZE:
1 in. (25,4 mm)

ADJUSTABLE SIDE PARALLAX:
50 M TO INFINITY

- High magnification extends your long-range shooting capability
- Ergonomic side focus allows easy-to-reach parallax adjustment



FULLFIELD E1 RIFLESCOPE 6.5-20x50mm

ITEM NUMBER:
200341

RETICLE:
BALLISTIC PLEX E1™ MV

MAIN TUBE SIZE:
1 in. (25,4 mm)

ADJUSTABLE SIDE PARALLAX:
50 M TO INFINITY

- High magnification extends your long-range shooting capability
- Ergonomic side focus allows easy-to-reach parallax adjustment



SERIES FEATURES

- State-of-the-art Ballistic Plex E1™ reticle features trajectory compensation out to 500 yards with cascading dots to compensate for crosswinds
- High-grade optical glass provides excellent brightness and clarity with lasting durability
- Quality, precision-ground lenses are larger than those of comparable scopes, for better light transmission
- Index-matched, HiLume™ multicoating aids in low-light performance and glare elimination, increasing your success rate
- Finger-adjustable windage and elevation knobs create a sleek profile; knob indications always reflect a change in the point of impact for pinpoint accuracy

SIMPLE, ACCURATE, EASY TO USE

The Ballistic Plex E1 features a durable etched glass reticle that simplifies the biggest challenges in long-distance shooting: determining holdover at distance and hold-off for wind drift., the hash marks on lower vertical crosshair are calibrated for dead-on aiming from 100 to 500 m. for nearly any big-game hunting cartridge. Cascading dots help you quickly and easily adjust for wind.



Burris

RT-6™

RIFLESCOPE



Speed reigns supreme in any hunting situation. So if you want to be successful, you better be fast on the target and fast to shoot. The RT-6™ is guaranteed to save seconds off the clock.



WATERPROOF



SHOCKPROOF



FOGPROOF



NITROGEN-FILLED

RETICLES



NEW

RT-6 RIFLESCOPE 1-6x24mm

ITEM NUMBERS:
200472,
200478 (4A-I)

RETICLE:
BALLISTIC AR™
4A-I

MAIN TUBE SIZE:
30 mm

- Illuminated reticle with 11 levels of illumination
- Integrated adjustable throw lever
- Available in matte black

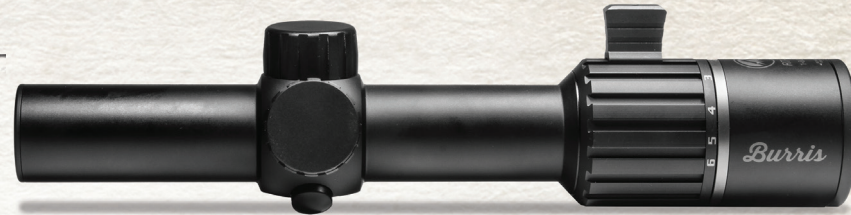

RT-6 RIFLESCOPE COMBO KIT 1-6x24mm

ITEM NUMBERS:
200475

RETICLE:
BALLISTIC AR™

MAIN TUBE SIZE:
30 mm

- Available in Combo Kit with P.E.P.R.™ Mount and FastFire 3
- Illuminated reticle with 11 levels of illumination
- Integrated adjustable throw lever
- Available in matte black



SERIES FEATURES

- **NEW:** Illuminated 4A reticle for the European hunting market
- Shorter than most 1-6x scopes for quicker, easier handling
- A 6x zoom with true 1x low power (optional) setting for both eyes open engagement.
- Ballistic AR™ mil reticle with trajectory compensation out to 600 meters
- Patented integrated adjustable throw lever

SPEED AND ACCURACY. ACCURACY AND SPEED.

Whichever you want first, the Burris RT-6 delivers. The Ballistic AR mil reticle combines a very fast target-acquisition center with trajectory compensation for distance shots. Even the patented built-in throw lever is all about speed: it is adjustable, and can be moved both fore and aft, as well as rotated to the exact starting point you prefer.



Burris
RT-1™
 RED DOT SIGHT



Everything about the Burris RT-1™ was designed for competition and tactical shooting. It's short and lightweight for quicker, easier handling. The 1x is ideal for both-eyes-wide-open target acquisition.

RETICLE



WATERPROOF



SHOCKPROOF



FOGPROOF



2 MOA Dot

NEW

RT-1 1-6x24mm

ITEM NUMBERS:
300261
RETICLE:
2 MOA DOT

- Compact, durable construction
- True 1x magnification
- Longer Battery Life
- Comes with high and low base mounts



SERIES FEATURES

- The RT Series was designed for competition and tactical shooting
- True 1x zoom for both-eyes-wide-open target acquisition.
- 8,000 hours of Battery life
- 2 MOA Illuminated Aiming point
- 1-piece aluminum Body for high ruggedness
- included in packaging is mounting options for High and Low requirements.

**SPEED AND ACCURACY.
ACCURACY AND SPEED.**

The RT Series was designed for competition and tactical shooting without breaking the bank. To accompany the existing RT riflescope line, Burris is offering two new sights. RT-1 is a true 1x magnification for fast target acquisition and both eyes open shooting. Its comes with a high and low base mount so you can customize the fit to your specific weapon and cheek weld. It's small footprint and lightweight makes it handle like a dream.



Burris FASTFIRE™

RED DOT SIGHTS



Light and tough, the FastFire series puts an unmistakable, bright red dot on your target to give you an immediate speed and accuracy advantage. Can be used as a primary sight or paired on top of an existing sight.



WATERPROOF



SHOCKPROOF

RETICLES



3 MOA Dot

8 MOA Dot

FASTFIRE IV MULTIRETICLE



11 MOA

11 MOA
and Circle

3 MOA,
Circle & Wings

2 MOA Dot



NEW FASTFIRE IV

ITEM NUMBERS:
300259

RETICLE:
MULTI-RETICLE

- Toggle between four different reticles
- Impact resistant housing
- Brighter aiming point with longer battery life
- Bigger sight window for faster target acquisition
- Removable weather shield stays attached when slide mounted.



NEW FASTFIRE RD

ITEM NUMBERS: DOT SIZE:
300260 2 MOA

- FastFire RD (Rifle Dot) features a 2 MOA red dot
- Brighter dot with longer battery life
- Fits Weaver-style/Picatinny rails
- Rugged alloy housing is impact resistant



FASTFIRE III

ITEM NUMBERS:
300234

DOT SIZE:
3 MOA

ITEM NUMBERS:
300236

DOT SIZE:
8 MOA

- Automatic brightness sensor adjusts brightness to match the environmental conditions; also has 3 manual brightness settings
- Battery access is conveniently located on the top of the sight; automatic time-out feature helps battery last up to 5 years
- Including Picatinny mount for mounting on rifles, handguns, and tactical shotguns
- Additional mounts upon request



UNIQUE 1-STOP BATTERY REPLACEMENT

- Battery access from top
- No dismounting necessary
- No change of POI
- Low battery indicator – no more sudden power loss. You can replace the battery on time and your equipment is ready when you are.



INNOVATIVE PROTECTIVE CAP

The included lens cover protects the sight from rain and snow ensuring a clear vision. It can be left on for quick shots thanks to transparent cap covers.

only **FASTFIRE III**

SERIES FEATURES

- Bright red dot allows for fast target acquisition and easy aiming
- 1x magnification allows for both-eyes-open shooting, for enhanced awareness and target acquisition
- Parallax-free, for better accuracy
- Mounts to almost anything—including handguns, rifles and shotguns—and the shockproof design stands up to years of punishing recoil
- Windage and elevation adjustments make fine-tuning easy

INTELLIGENT BRIGHTNESS CONTROL

You can adjust the brightness manually to three different levels.

Alternatively you can use the electronic control that automatically adjusts the brightness for you.

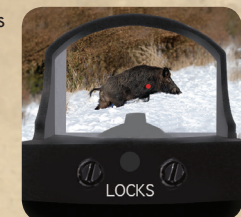



RINGS, MOUNTS, RETICLES
AND ACCESSORIES

SOLID FOUNDATION FOR SUCCESS

Burris has built a reputation for some of the most solid, reliable rings and bases on the market. Our quality rings, mounts and accessories create the perfect shooting solution. You'll stay on target round after round with gear from Burris.





Burris

RINGS & MOUNTS

Hunters and tactical shooters count on Burris mounting solutions, with a wide variety of options that securely mount a riflescope onto any Weaver or Picatinny-style rail. These rings and bases provide long-lasting holding power and durability for hunters, duty officers and competitive shooters.



**AR-P.E.P.R.
Quick-Detach
Model**

AR-P.E.P.R.™ MOUNTS

- Full ring and base mounting solution in one
- Allows up to 2 inches of forward scope positioning
- Provides optimum eye relief and full field of view
- Includes both smooth and Picatinny ring tops
- Quick-detach models allow for fast mounting

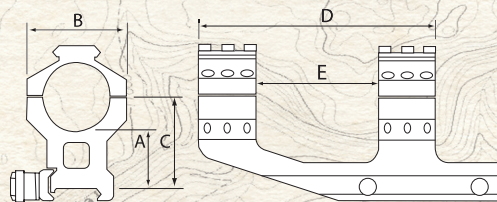

Item	Size	Weight	Dimensions					QD MOUNT	CANT
			A	B	C	D	E		
410341	30 mm	8.7 oz.	1.00 in.	1.75 in.	1.60 in.	4.15 in.	2.15 in.		0 MOA
410342	30 mm	8.7 oz.	1.00 in.	1.75 in.	1.60 in.	4.15 in.	2.15 in.	•	0 MOA
410343	1 in.	8.3 oz.	1.00 in.	1.57 in.	1.50 in.	4.15 in.	2.15 in.		0 MOA
410344	1 in.	8.3 oz.	1.00 in.	1.57 in.	1.50 in.	4.15 in.	2.15 in.	•	0 MOA
410345	34 mm	6.9 oz.	0.68 in.	1.90 in.	1.35 in.	4.90 in.	2.90 in.		20 MOA

AR-SIGNATURE QD™ P.E.P.R.™ MOUNTS

- The new streamlined design with QD mount insures 1/4 MOA re-mount capability and allows for use of back up iron sights while maintaining proper eye-relief. Available in 30-, 34- and 35-mm options with Burris' Signature polymer ring inserts, it provides adjustment from 5 to 40 MOA without using windage/elevation knobs.

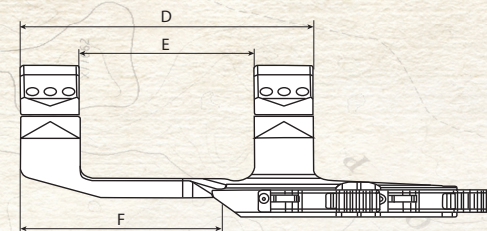
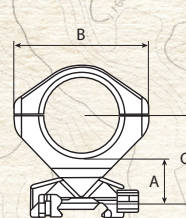

Item	Size	Weight	Dimensions						QD MOUNT
			A	B	C	D	E	F	
410352	30 mm	10.33 oz.	.81 in.	2.13 in.	1.5 in.	5.0 in.	3.0 in.	3.45 in.	•
410353	34 mm	10.09 oz.	.76 in.	2.28 in.	1.5 in.	5.0 in.	3.0 in.	3.45 in.	•
410354	35 mm	10.09 oz.	.76 in.	2.28 in.	1.5 in.	5.0 in.	3.0 in.	3.45 in.	•



XTR RINGS™

- 1 in. and 30 mm models are lightweight aluminum with incredible holding power
- Quick-detach models allow fast mounting

Item	Size	Quick-Detach	Aluminum	Steel	1 Ring	2-Ring Set
Low						
420160	30 mm		•			•
420161	30 mm		•		•	
420180	1 in.		•			•
Medium						
420162	30 mm		•			•
420163	30 mm		•		•	
420181	1 in.		•			•
High						
420164	30 mm		•			•
420165	30 mm		•		•	
420182	1 in.		•			•
Extra-High						
420166	30 mm		•			•
420167	30 mm		•		•	
420183	1 in.		•			•
Picatinny Ring Top - allows attachment of accessories on top of mounted scope						
420169	30 mm		•		•	



Low



Extra-High

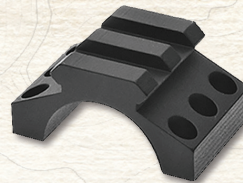

Picatinny Ring Top



High



Low



Pos-Align® Offset Inserts

XTR SIGNATURE RINGS™

- Provide precision customization of cant to maximize usable elevation adjustment of the scope. Included inserts allow for 5, 10, 15, 20, 25, 30 and 40 MOA of cant
- Provide 100% scope-to-ring contact, eliminating the need to lap rings while providing tremendous gripping power without leaving ring marks
- Strong, lightweight aluminum rings feature solid steel dual screw clamps that insure each ring mounts flat and centered on any Picatinny base
- Includes the following Pos-Align® Offset Inserts: Concentric (Zero MOA), +/-5 MOA, +/-10 MOA, and +/-20 MOA (2 sets)

RING HEIGHTS

These are the dimensions of XTR Signature Rings, from the center of the scope to the top of the mount base.

Item	Height	Size	Item	Height	Size
420210	1.00 in.	34 mm	420223	1.50 in.	30 mm
420211	1.50 in.	34 mm	420231	1.00 in.	1 in.
420221	1.00 in.	30 mm	420232	1.25 in.	1 in.
420222	1.25 in.	30 mm	420233	1.50 in.	1 in.

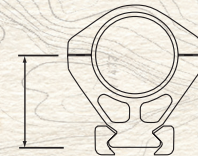

RING HEIGHTS

These are the dimensions of Xtreme Tactical Rings, from the center of the scope to the top of the mount base.

	Low	Medium	High	Extra-High
30 mm	0.85 in.	1.10 in.	1.35 in.	1.60 in.
1 in.	0.75 in.	1.00 in.	1.25 in.	1.50 in.

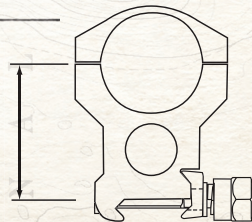

1/2-INCH PICATINNY RISER

- Provides 1/2 inch of additional mounting height for optimal sight alignment on tactical platforms

Item	Height	Length
410340	0.5 in.	1.5 in.

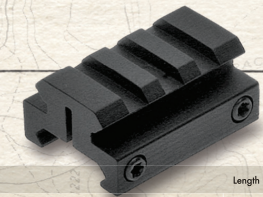



SIGNATURE RINGS

- Revolutionary Pos-Align® Inserts technology
- Pos-Align Inserts guarantee perfect centering and maximum scope-to-ring contact for tremendous gripping power without damaging the scope finish
- Lets you virtually sight in your gun without moving the scope adjustments
- Corrects misalignment caused by off-center receiver holes
- Corrects for bases or rings being slightly off-center
- No need for expensive tapered bases or shimming for thousand-yard shooting
- Solid steel rings are ideal for hunting



Signature Universal Dovetail Rings

Item	Size	Height	Finish
Signature Universal Dovetail			
420501	1 in.	Medium	Matte
420511	1 in.	High	Matte
420578*	30 mm	Medium	Matte
420581*	30 mm	High	Matte
420582*	30 mm	Extra-High	Matte
Signature Double Dovetail			
420561	1 in.	Medium	Matte

Signature Zee Rings

Item	Size	Height	Finish
Signature Zee Rings (Weaver-Style)			
420520	1 in.	Medium	Black Gloss
420521	1 in.	Medium	Matte
420522	1 in.	Medium	Nickel
420530	1 in.	High	Black Gloss
420531	1 in.	High	Matte
420532	1 in.	High	Nickel
420585*	30 mm	Extra-High	Matte
420587*	30 mm	High	Matte
420588*	30 mm	Medium	Matte

Signature Rimfire/Airgun Rings

Item	Size	Height	Finish
Signature Rimfire/Airgun			
420554	1 in.	Medium	Matte
420556	1 in.	High	Matte

Comes with clamps for 11 mm and 3/8" dovetails

Pos-Align® Offset Inserts

Signature Pos-Align® Offset Inserts	
Installation Kit	
626019	1 each of +/- .005, +/- .010, +/- .020
Gunsmith Kit	
626024	10 each of +/- .005, +/- .010, +/- .020
Individual Inserts	
626017	+/- .010 Eccentric Offset
626018	+/- .020 Eccentric Offset

*30 mm comes with "zero" inserts and +/- .010 inserts for both front and rear rings.



RUGER®-TO-WEAVER BASE ADAPTER

- For use with Zee Rings
- Mounts optics onto Ruger® firearms that feature the proprietary Ruger® integral mounting system

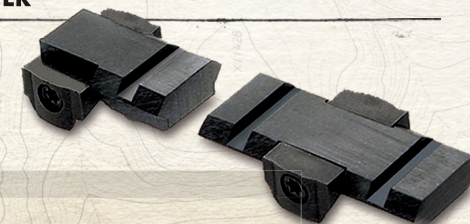

Item	Compatible with Ruger® Firearm
410990	M77®, Super Redhawk®
410991	No. 1, 77/22®, 77ML®, 77/44®, Mini-14®, Redhawk®
410992	M77® for use with Eliminator® LaserScope®

ZEE RINGS

- Tough, solid steel
- Weaver-style
- Machined to exacting tolerances to handle recoil or abuse

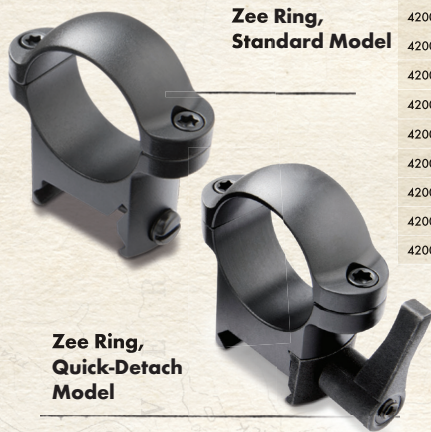

Item	Size	Height	Finish	Quick-Detach
Weaver-Style				
420031	1 in.	Low	Matte	•
420034	1 in.	Medium	Matte	•
420037	1 in.	High	Matte	•
420044	30 mm	Medium	Matte	
420077	30 mm	High	Matte	
420079	1 in.	Low	Nickel	
420080	1 in.	Low	Black Gloss	
420081	1 in.	Medium	Black Gloss	
420082	1 in.	High	Black Gloss	
420083	1 in.	Low	Matte	
420084	1 in.	Medium	Matte	
420085	1 in.	Medium	Nickel	
420086	1 in.	High	Nickel	
420087	1 in.	High	Matte	

CZ-STYLE RINGS

- Solid steel
- Designed for mounting optics on CZ rifles

Item	Size	Height	Finish	Action
CZ 550				
420130	1 in.	Medium	Matte	Long-Action
CZ 527				
420140	1 in.	Medium	Matte	Short-Action



TIKKA® T3® RINGS

- Solid steel
- Ring and base solution specifically designed for Tikka® T3® rifle

Item	Size	Height	Finish
Tikka T3 Rings			
420135	1 in.	Medium	Matte
420136	30 mm	Medium	Matte
420137	30 mm	High	Matte



RIMFIRE/AIRGUN RINGS

- Available in solid steel or aluminum
- Securely mount your rimfire or airgun optic

Item	Size	Height	Finish	Material	Quick-Detach
.22 Ring Pairs (fits in 22-in. grooved receivers)					
420069	1 in.	Medium	Matte	Steel	
420072	1 in.	Medium	Black Gloss	Steel	
420073	1 in.	High	Black Gloss	Steel	
420076	1 in.	High	Matte	Steel	
420068	1 in.	Medium	Matte	Steel	•



RING HEIGHTS

Ring Heights	Low	Medium	High	Extra-High
Signature 1 In.		0.77	0.89	
Standard 30 mm & Signature 30 mm		0.78	0.89	1.02
Zee 1 In. & Quick-Detach 1 In.	0.63	0.76	0.95	
Zee Signature 1 In.		0.77	0.92	
Zee 30 mm & Zee Signature 30 mm		0.81	0.93	1.18
CZ (All)		1.00		
.22 Signature Deluxe		0.90	1.29	
1-In. .22 Rings (All)		0.80	0.95	
Tikka T3		1.125	1.250	

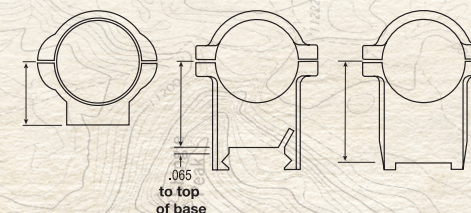

Dimensions listed are from the center line of the scope tube to the bottom of the ring.



XTREME TACTICAL™ 2-PIECE BASES

- Solid steel bases work with all Weaver-style, Picatinny-style, and mil-spec rings
- Engineered with minimal height and weight
- Mil-spec cross slots guarantee rock-solid attachment
- Matte finish

Item	Style	Reversible Front Base
410600	XTB-700/7 (Remington® 700 & 7 Short & Long)	•
410605	XTB-70/Express (Winchester® 70 Short, Long & Express)	•
410606	XTB-70 WSS (Winchester® 70 Short, Long & SXR)	•
410615	XTB-SavR (Savage® Short & Long Round Rear)	•
410620	XTB-SavF (Savage® Short & Long Flat Rear)	•
410625	XTB-ABOLT (Browning® A-Bolt Short & Long)	•
410630	XTB-TIKKA® (Tikka®)	•
410635	XTB-SAKO® Dovetail (SAKO® Dovetail Steel Base Low Profile)	

XTREME TACTICAL™ 1 PIECE BASES

The new Xtreme Tactical one-piece bases offer the perfect mounting solution for precision shooters. In addition to greater strength and rigidity, the 25 MOA cant offers extended range capability.

- Milled from a single piece of solid steel
- Compatible with all Weaver-style, Picatinny-style rings
- Designed to work with both short and long actions
- Matte finish

Item	Style	MOA Cant
410650	XTB-Sav Round Rear Long	25
410651	XTB-Sav Round Rear Short	25
410652	XTB-700 Long Action - Howa 1500 Long Action	25
410653	XTB-700 Short Action	25
410655	XTB-Howa 1500 Short Action	25
410658	XTB-TIKKA® (Tikka®)	25
410660	XTB-Sav Round Rear Long	No Cant
410661	XTB-Sav Round Rear Short	No Cant
410662	XTB-700 Long Action - Howa 1500 Long Action	No Cant
410663	XTB-700 Short Action	No Cant
410665	XTB-Howa 1500 Short Action	No Cant
410668	XTB-TIKKA® (Tikka®)	No Cant





42 HUNTING SPECIFICATIONS



Ballistic® III LaserScope® Series

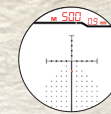

X96 Reticle

Item	Magnification	Objective End Diameter	Clear Objective Diameter	Ocular End Diameter	Laser Range (Environmental conditions may limit range)	Operating Temperature	Reticle	Illumination	Focal Plane	Finish	Field of View (Low to High, @ 100 m)	Eye Relief	Exit Pupil (Low to High)	Click Value	Elevation Adjustment, Total Capability*	Windage Adjustment, Total Capability*	Parallax/Focus	Length	Weight [†]	Battery	Mounting Rail Length	Remote Cable Switch
4-16x50mm																						
200117	4-16x	65 mm	50 mm	42 mm	690 m (non-reflective) – 1100+ m (reflective)	–25°C to +50°C	X96	•	RFP	Matte	8 – 2,1 m	88,9 – 101,6 mm	12,5 – 3,1 mm	1/8 MOA	40 MOA	40 MOA	Objective PA	394 mm	862 g	CR123A	216 mm	No
*Example: 50 MOA is roughly 25 MOA in any direction from center				[†] Weight includes mount and battery																		

*Example: 50 MOA is roughly 25 MOA in any direction from center †Weight includes mount and battery



Four Xe Riflescopes Series



Reticle 4 Illuminated

Ballistic E3

SCR MIL

Item	Magnification	Objective End Diameter	Clear Objective Diameter	Ocular End Diameter	Reticle	Focal Plane	Main Tube Size	Finish	Field of View (Low to High, @ 100 m.)	Eye Relief	Exit Pupil (Low to High)	Click Value	Elevation Adjustment, Total Capability*	Windage Adjustment, Total Capability*	Parallax/Focus	Length
1-4x24mm																
200502	1-4x	30 mm	24 mm	45.4 mm	3P#4	Second	30 mm	Black-Matte	43,5 – 10,2 m	89-91 mm	12,3 - 6,3 mm	2 cm@100m	70 MOA	70 MOA	-	262 mm
2,5-10x50mm																
200503	2,5-10x	57.5 mm	50 mm	45.4 mm	3P#4	Second	30 mm	Black-Matte	16,6 – 4,0 m	99-102 mm	13,5 - 6,0 mm	1 cm@100m	60 MOA	60 MOA	-	348 mm
3-12x56mm																
200504	3-12x	63.5 mm	56 mm	45.4 mm	3P#4	Second	30 mm	Black-Matte	14,0 – 3,4 m	109-114 mm	13,8 - 5,7 mm	1 cm@100m	60 MOA	60 MOA	-	372 mm
6-24x56mm/6-24x50mm																
200505 Low Profile Turrets	6-24x	63.5 mm	56 mm	45.4 mm	E3	Second	30 mm	Black-Matte	5,7 – 1,6 m	84-91 mm	9,6 - 2,9 mm	1 cm@100m	25 MOA	25 MOA	25x - infinity	383 mm
200506 High Profile Turrets	6-24x	57.5 mm	50 mm	45.4 mm	SCR MIL	Second	30 mm	Black-Matte	5,7 – 1,6 m	84-91 mm	8,5 - 2,6 mm	1 cm@100m	25 MOA	25 MOA	25x - infinity	383 mm

*Example: 50 MOA is roughly 25 MOA in any direction from center



Six Xe Riflescopes Series



Reticle 4 Illuminated

Ballistic E3

SCR MIL

Item	Magnification	Objective End Diameter	Clear Objective Diameter	Ocular End Diameter	Reticle	Focal Plane	Main Tube Size	Finish	Field of View (Low to High, @ 100 m.)	Eye Relief	Exit Pupil (Low to High)	Click Value	Elevation Adjustment, Total Capability*	Windage Adjustment, Total Capability*	Parallax/Focus	Length
1-6x24mm																
200626	1-6x	30 mm	24 mm	46.5 mm	3P#4	Second	30 mm	Black-Matte	40.3 m - 6.8 m	95 mm	12.3 - 6.3 mm	1 cm@100m	140 MOA	140 MOA	-	275 mm
3-18x56mm																
200627	3-18x	63.5 mm	56 mm	46.5 mm	E3	Second	30 mm	Black-Matte	14.7 m - 2.6 m	102 mm	13.5 - 6.0 mm	1 cm@100m	80 MOA	80 MOA	-	335 mm
3-18x56mm																
200628	3-18x	63.5 mm	56 mm	46.5 mm	SCR MIL	Second	30 mm	Black-Matte	14.7 m - 2.6 m	102 mm	13.5 - 6.0 mm	1 cm@100m	80 MOA	80 MOA	-	335 mm

*Example: 50 MOA is roughly 25 MOA in any direction from center

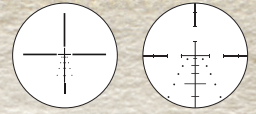

Fullfield E1™ Riflescopes Series



Item	Magnification	Objective End Diameter	Clear Objective Diameter	Ocular End Diameter	Reticle	Focal Plane	Main Tube Size	Finish	Field of View (Low to High, @ 100 m.)	Eye Relief	Exit Pupil (Low to High)	Click Value	Elevation Adjustment, Total Capability*	Windage Adjustment, Total Capability*	Parallax/Focus	Length	Weight
3-9x40mm																	
200320	3-9x	48 mm	40 mm	39 mm	Ballistic Plex E1™	RFP	1 in. (25,4 mm)	Matte	10,1 – 4 m	78,7 – 86,4 mm	13 – 5 mm	1/4 MOA	50 MOA	50 MOA		310 mm	370 g
4.5-14x42mm																	
200338	4.5-14x	51.5 mm	42 mm	39 mm	Ballistic Plex E1™	RFP	1 in. (25,4 mm)	Matte	6,7 – 2,3 m	78,7 – 96,5 mm	9 – 3 mm	1/4 MOA	40 MOA	40 MOA	Side Focus/PA	320 mm	434 g
6.5-20x50mm																	
200341	6.5-20x	63 mm	50 mm	39 mm	Ballistic Plex E1™ MV	RFP	1 in. (25,4 mm)	Matte	5,5 – 1,8 m	78,7 – 91,4 mm	7,6 – 2,5 mm	1/4 MOA	30 MOA	30 MOA	Side Focus/PA	356 mm	479 g

*Example: 50 MOA is roughly 25 MOA in any direction from center

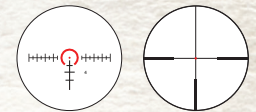

RT-6 Riflescopes™ Series



Item	Magnification	Objective End Diameter	Clear Objective Diameter	Ocular End Diameter	Reticle	Illumination	Focal Plane	Main Tube Size	Finish	Field of View (Low to High, @ 100 m.)	Eye Relief	Exit Pupil (Low to High)	Click Value	Elevation Adjustment, Total Capability*	Windage Adjustment, Total Capability*	Parallax/Focus	Length	Weight	Battery
1-6X24mm																			
200472	1-6x	30 mm	24 mm	46 mm	Ballistic AR™	•	RFP	30 mm	Matte	32 – 5,6 m	84 – 102 mm	11,5-5,2 mm	1/2 MOA	80 MOA	80 MOA		262 mm	493 g	CR2032
200478	1-6x	30 mm	24 mm	46 mm	4A-I	•	RFP	30 mm	Matte	32 – 5,6 m	84 – 102 mm	11,5-5,2 mm	1/2 MOA	80 MOA	80 MOA		262 mm	493 g	CR2032
1-6X24mm Combo Kit																			
200475	1-6x	30 mm	24 mm	46 mm	Ballistic AR™	•	RFP	30 mm	Matte	32 – 5,6 m	84 – 102 mm	11,5-5,2 mm	1/2 MOA	80 MOA	80 MOA		262 mm	720 g	CR2032

Tactical kit includes scope, FastFire™ 3, and AR-PE.PR.™ Mount

*Example: 50 MOA is roughly 25 MOA in any direction from center

HUNTING SPECIFICATIONS

44

BURRIS OPTICS 2022



Thermal Series

Item	Magnification	Resolution	Pixel Size	Frame Rate	Focal Length	Focusing	Visual Angle	Digital Zoom	Eye Relief	Dioptric Compensation	Screen	Color Palettes	Adapter/Battery	Working Hours	Mounting Type	Weight	Dimensions
BTH 50																	
300469	3.3-13.2x	400x300	17µm	50Hz	50mm F1.2	manual	7.8°x5.8°	1x-4x	10mm	-4~+2	1280x960 color LCOS	White Hot, Black Hot, Iron Red, Blue Hot, Red Hot	USB-C	≥5 hours @25°C	-	536 g	213 x 65 x 71 mm
BTH 35																	
300468	2.3-9.2x	400x300	17µm	50Hz	35mm F1.2	manual	11.1°x8.3°	1x-4x	10mm	-4~+2	1280x960 color LCOS	White Hot, Black Hot, Iron Red, Blue Hot, Red Hot	USB-C	≥5 hours @25°C	-	485 g	193 x 65 x 71 mm
BTH 25																	
300467	1.7-6.8x	400x300	17µm	50Hz	25mm F1.2	manual	15.4°x11.6°	1x-4x	10mm	-4~+2	1280x960 color LCOS	White Hot, Black Hot, Iron Red, Blue Hot, Red Hot	USB-C	≥5 hours @25°C	-	470 g	193 x 65 x 71 mm
BTC 50																	
300628	1x	400x300	17µm	50Hz	50mm F1.2	manual	7.5°x5.6°	2x, 4x	10mm	-	1024x768 Color OLED	Black hot, white hot, red hot, green hot	2x CR123/ICR 16340	≥3 hours	Dayscope Objective lens adapter	400 g	178 x 58 x 61 mm
BTC 35																	
300629	1x	400x300	17µm	50Hz	35mm F1.2	manual	10.6°x8.0°	2x, 4x	10mm	-	1024x768 Color OLED	Black hot, white hot, red hot, green hot	2x CR123/ICR 16340	≥3 hours	Dayscope Objective lens adapter	451 g	150 x 51 x 56 mm
BTS 50																	
300618	1x	400x300	17µm	50Hz	50mm F1.2	manual	7.5°x5.6°	2x, 4x	48mm	-	1024x768 Color OLED	Black hot, white hot, red hot, green hot, blue hot	1x18650	≥3h standard	Picatinny rail	726 g	249 x 89 x 75 mm
BTS 35																	
300619	1x	400x300	17µm	50Hz	35mm F1.2	manual	10.7°x8.0°	2x, 4x	48mm	-	1024x768 Color OLED	Black hot, white hot, red hot, green hot, blue hot	1x18650	≥3h standard	Picatinny rail	658 g	229 x 89 x 75 mm

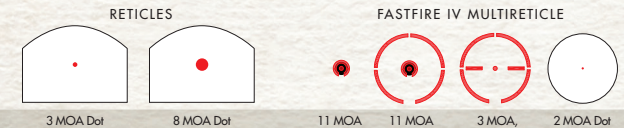

FastFire™ Series

Item	Clear Objective Diameter	Reticle	Reticle Color(s)	Illumination	Finish	Mount	Eye Relief	Click Value	Elevation Adjustment, Total Capability*	Windage Adjustment, Total Capability*	Parallax/Focus	Length	Weight	Battery
FastFire™ 3														
300234	21x15 mm	3 MOA Dot	Red	•	Matte	Picatinny Mount	Unlimited	1 MOA	115 MOA	86 MOA	Parallax-free	48 mm	43 g	CR1632
300236	21x15 mm	8 MOA Dot	Red	•	Matte	Picatinny Mount	Unlimited	1 MOA	115 MOA	86 MOA	Parallax-free	48 mm	43 g	CR1632
FastFire™ 4														
300259	-	Multi-Reticle	Red	•	Matte	Picatinny Mount / Doctor Optic	Infinite	1 MOA	90 MOA	90 MOA	-	48 mm	45 g	CR1632
FastFire™ RD														
300260	35.5 mm	2 MOA Dot	Red	•	Matte	Picatinny Mount	Infinite	1 MOA	90 MOA	90 MOA	-	66 mm	181 g	AAA

*Example: 50 MOA is roughly 25 MOA from center



RT Series - Prisms

Item	Magnification	Objective End Diameter	Clear Objective Diameter	Ocular End Diameter	Reticle	Illumination	Finish	Mount	Eye Relief	Click Value	Elevation Travel	Windage Travel	Length	Weight	Battery
RT-1															
300261	1x	33.5 mm	25 mm	24 mm	2 MOA Dot	•	Matte	Picatinny	Infinite	0.5 MOA	45 MOA	45 MOA	69,85 mm	136g	CR2032

INTERNATIONAL DISTRIBUTOR:

STEINER-OPTIK GMBH

Dr.-Hans-Frisch-Str. 9 · 95448 Bayreuth · Germany

Costumer-service-international@steiner.de

Phone +49 921 7879-15 · Fax +49 921 7879-89





Burris

FIND WHAT MATTERS

DO NOT DISTURB THE ENVIRONMENT